

Track Light

LED Track Light

IP65

5
WARRANTY



LED Track Light

Part Number	LOT-TR-15-3	LLOT-TR-20-3	LOT-TR-25-3
Lumen Output	1,164lm	1,460lm	2,071lm
Wattage	15W	20W	28W
Lumen Efficacy	115lm/W		
CCT	2700k/3000k/4000k		
Beam Angle	11°/22°/36°		
Input Voltage	220-240Vac 50-60Hz PF 0.95		
IP Rating	IP 20		
LED Driver	Meanwell		
Certification	UL, CE, PSE, SAA, RoHS		

Installation

1. Please install the related track rail before install the light (Picture one)
2. Aim the track head to the track rail then push up, make sure the track head are total match into the track rail (Picture two)
3. After install the track head into the track rail, rotate track rail and spindle 90° counterclockwise (Picture three)
4. Adjust the track light's light direction, the switch on, twist the switch into one/two/three position

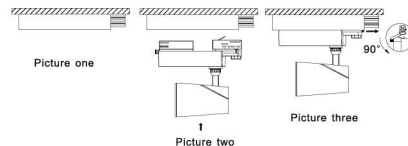

Detail

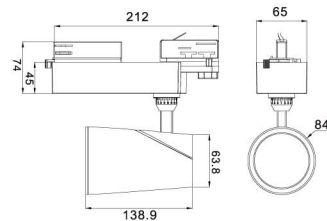

(Unit: mm)

www.lightingoftomorrow.com

1-800-538-4446

LED Technology

The LED Track Light can provide the perfect glare-free lighting for places such as stores, workshops, galleries, museums, and malls. This product has an advanced, patented design with its ultra-thin hybrid optical lenses that allows first-rate lighting control. This product also comes with a variety of built-in optical accessories to adapt to any lighting position as preferred. This product comes with an anti-glare function so that it can provide a stable, uniform lighting. This track light has an easy application, installment, and assembling. It has a long lifespan, with over 40,000 hours of consistent lighting.

